

**STRIPING AND SIGNAGE NOTES**

1. ALL TRAFFIC STRIPES AND PAVEMENT MARKINGS SHALL BE THERMOPLASTIC.
2. DETAIL NUMBERS REFER TO CALTRANS STANDARD PLANS A20 AND A24.
3. ALL DIMENSIONS ARE IN FEET UNLESS OTHERWISE NOTED.
4. ALL STRIPING AND PAVEMENT MARKINGS SHALL BE APPLIED BY THE EXTRUSION METHOD ONLY.
5. CAT TRACKING SHALL BE BY COUNTY FORCES.
6. REMOVE BY GRINDING ALL STRIPING THAT CONFLICTS WITH PROPOSED STRIPING.

**LEGEND**

- ① NEW SIGN. SEE SIGN SCHEDULE ON SHEET C4.2.
- ⓧ SEE CALTRANS STANDARD PLAN "XX"

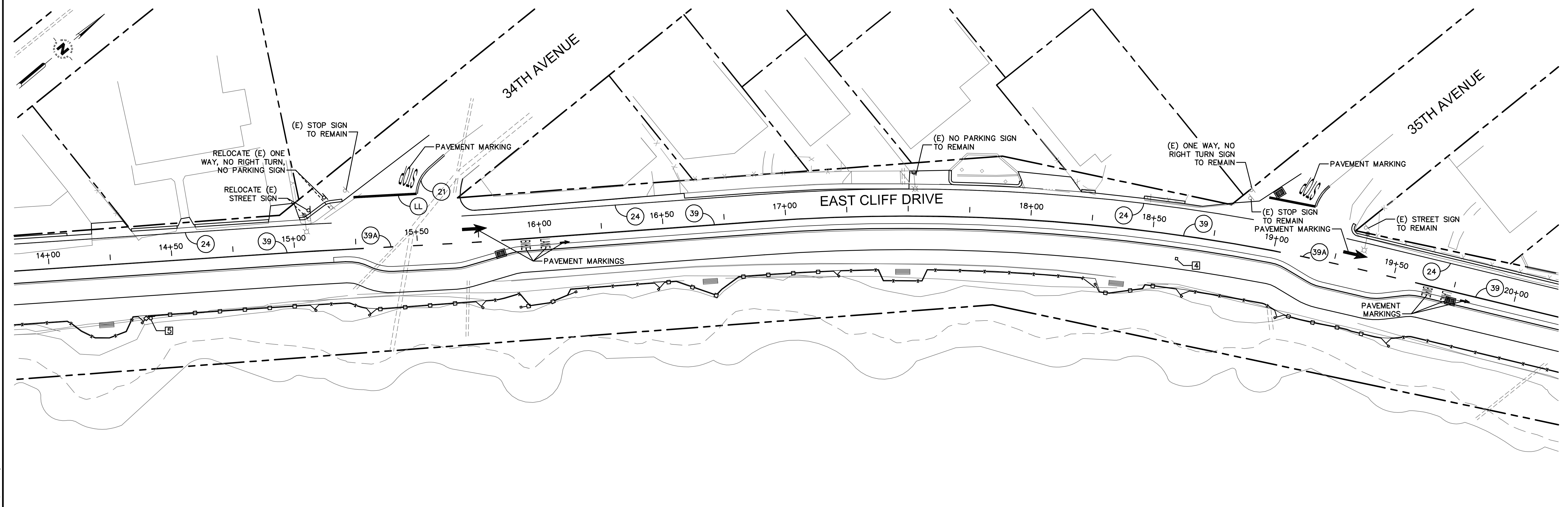

**STRIPING AND SIGNAGE PLAN STA 10+00 - 20+00**  
SCALE: 1" = 20'

**WHITSON ENGINEERS**  
2425 Porter Street - Suite 2 - Soquel, CA 95073  
831 464-9363 - Fax 831 464-2316  
CIVIL ENGINEERING - LAND SURVEYING - PROJECT MANAGEMENT



County of Santa Cruz  
Department of Public Works  
701 Ocean St., Rm. 410  
Santa Cruz, CA 95060-4000  
Phone: (831) 452-2180  
Fax: (831) 454-2265

STRIPING AND SIGNAGE PLAN  
STA 10+00 - STA 20+00  
EAST CLIFF DRIVE PARKWAY PROJECT  
32nd AVENUE TO 41st AVENUE  
County of Santa Cruz  
California

REV	BY	DATE	DESCRIPTION
1		03/22/10	75% SUBMITTAL
2		10/08/10	95% SUBMITTAL
3		07/12/11	BID SET

DATE: SEPTEMBER 2010  
SCALE: AS NOTED  
DESIGNED BY: MS/RT  
DRAFTED BY: RT/SG  
CHECKED BY: KW  
JOB NO.: 2280.01  
FILE: Civil Plan.dwg

**C4.0**

A:\03\_2011\10\_2280\10\_2280.dwg